

LK8

Series

Jaw Coupling - Clamp Type

Features

- Absorb vibration
- Adjust misalignment of parallel, angular and shaft end-play
- Resistance to oil and electrical insulation
- Zero backlash
- 4 different hardness elastic spiders are available



Order Information

LK8		C40		14	H7		18	H7		R
Series No.	-	Size	Blank: Standard K: Keyway both ends	Finish bore d1	Tolerance Blank: H8	-	Finish bore d2	Tolerance Blank: H8	-	Red spider B-Blue, Y-Yellow, G-Green

Keyway Note:

When both bores are with keyway, code "K" should be added after the outer diameter of the coupling. If only one bore is with keyway, code "K" should be added after the tolerance code of the relative bore size only (Do not add to the outer diameter). If any customized dimension required, please consult us.

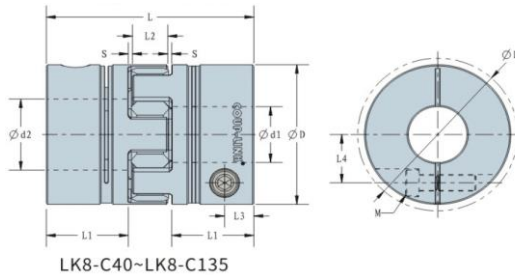
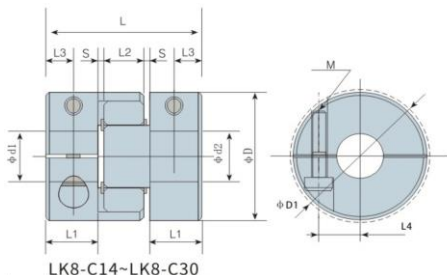

Dimensions

Unit: mm

Model	Φd1 Φd2		ΦD	ΦD1	L	L1	L2	S	L3	L4	Screw	Tightening Torque (N.m)
	Min. Bore	Max. Bore										
LK8-C14-□□-□□-□	3	7	14	19.0	21	7.05	5.3	0.8	3.50	5.00	M2.5	1.0-1.1
LK8-C20-□□-□□-□	5	10	20	22.5	30	10.50	7.0	1.0	5.25	7.00	M2.5	1.0-1.1
LK8-C25-□□-□□-□	6	12	25	30.0	34	11.20	9.6	1.0	5.60	9.00	M4	3.4-4.1
LK8-C30-□□-□□-□	8	16	30	34.0	35	11.50	9.6	1.2	5.75	11.50	M4	3.4-4.1
LK8-C40S-□□-□□-□	11	24	40	46.0	55	20.00	12.0	1.5	6.50	16.50	M5	7.0-8.5
LK8-C40-□□-□□-□	11	24	40	46.0	66	25.50	12.0	1.5	9.25	16.50	M5	7.0-8.5
LK8-C55-□□-□□-□	15	28	55	56.5	78	30.85	13.3	1.5	11.00	19.00	M6	14-15
LK8-C55-□□-□□-□-RL65	15	28	55	56.5	65	24.35	13.3	1.5	7.75	19.00	M6	14-15
LK8-C55-□□-□□-□-RL90	15	28	55	56.5	90	36.85	13.3	1.5	11.00	19.00	M6	14-15
LK8-C65-□□-□□-□	20	38	65	72.0	90	35.75	15.5	1.5	12.00	24.75	M8	30-35
LK8-C65-□□-□□-□-RL110	20	38	65	72.5	110	45.75	15.5	1.5	12.00	24.75	M8	30-35
LK8-C65-□□-□□-□-RL130	20	38	65	72.5	130	55.75	15.5	1.5	12.00	24.75	M8	30-35
LK8-C80-□□-□□-□	30	45	80	82.0	114	45.75	19.5	1.5	16.50	28.00	M8	30-35
LK8-C95-□□-□□-□	38	55	95	100.0	126	50.25	22.5	1.5	17.50	34.00	M10	65-68
LK8-C105-□□-□□-□	38	60	105	108.0	140	57.00	23.0	1.5	20.00	39.50	M10	65-68
LK8-C120-□□-□□-□	40	65	120	123.0	160	66.15	24.7	1.5	22.50	45.00	M12	100-110
LK8-C135-□□-□□-□	45	70	135	136.0	185	77.20	27.6	1.5	22.50	52.50	M12	100-110

Note:

1. For other bore sizes which are not listed above, customized ones are available, please consult us.
2. Standard bore tolerance is for the shaft with tolerance h7 or h8, if other tolerance is required, please consult us.
3. ΦD1 is the maximum rotation diameter if you need it to be consistent with the outer diameter of the product, please consult us.

Specifications

Model	Spider	Rated Torque (N.m)	Max. Rotation Speed (rpm)	Moment of Inertia (Kg.m²)	Static Torsional Stiffness (N.m / rad)	Allowable Misalignment			N.W. (g)
						Eccentricity (mm)	Angularity (°)	Shaft End-play (mm)	
LK8-C14-□□-□□-□	(B) 80 Sh A	0.7	27000	2.0x10 ⁷	8.6	0.15	1	0.6 0	7
	(Y) 90 Sh A	1.2			14	0.1			
	(R) 98 Sh A	2			22	0.06			
LK8-C20-□□-□□-□	(B) 80 Sh A	1.8	19000	1.06x10 ⁶	17	0.19	1	0.8 0	19
	(Y) 90 Sh A	3			31	0.13			
	(R) 98 Sh A	5			51	0.08			
LK8-C25-□□-□□-□	(B) 80 Sh A	3	15200	3.15x10 ⁶	54	0.2	1	0.9 0	32
	(Y) 90 Sh A	5			65	0.14			
	(R) 98 Sh A	9			85	0.08			
LK8-C30-□□-□□-□	(B) 80 Sh A	4	12700	6.15x10 ⁶	62	0.2	1	1 0	46
	(Y) 90 Sh A	7.5			73	0.15			
	(R) 98 Sh A	12.5			130	0.09			
LK8-C40S-□□-□□-□	(B) 80 Sh A	6	9550	3.01x10 ⁶	380	0.2	1	1.2 0	113
	(Y) 90 Sh A	12			570	0.1			
	(R) 98 Sh A	21			1200	0.06			
LK8-C40-□□-□□-□	(B) 80 Sh A	6	9550	3.66x10 ⁶	550	0.2	1	1.2 0	137
	(Y) 90 Sh A	12			570	0.1			
	(R) 98 Sh A	21			1200	0.06			
LK8-C55-□□-□□-□	(Y) 90 Sh A	35	6950	1.60x10 ⁴	1600	0.14	1	1.4 0	344
	(R) 98 Sh A	60			2600	0.1			
	(G) 64 Sh D	75			5030	0.07			
LK8-C55-□□-□□-□-RL65	(R) 98 Sh A	60	6950	1.36x10 ⁴	2600	0.1	0.9	1.4 0	312
LK8-C55-□□-□□-□-RL90	(R) 98 Sh A	60	6950	1.95x10 ⁴	2600	0.1	0.9	1.4 0	449
LK8-C65-□□-□□-□	(Y) 90 Sh A	95	5850	3.55x10 ⁴	3000	0.15	1	1.5 0	505
	(R) 98 Sh A	160			4900	0.1			
	(G) 64 Sh D	200			10260	0.08			
LK8-C65-□□-□□-□-RL110	(R) 98 Sh A	160	5850	4.64x10 ⁴	4900	0.1	0.9	1.5 0	737
LK8-C65-□□-□□-□-RL130	(R) 98 Sh A	160	5850	5.53x10 ⁴	4900	0.1	0.9	1.5 0	880
LK8-C80-□□-□□-□	(Y) 90 Sh A	190	4750	1.04x10 ³	5300	0.17	1	1.8 0	1006
	(R) 98 Sh A	325			6500	0.1			
	(G) 64 Sh D	405			16300	0.08			
LK8-C95-□□-□□-□	(Y) 90 Sh A	265	4000	2.27x10 ³	6200	0.19	1	2 0	1531
	(R) 98 Sh A	450			8900	0.1			
	(G) 64 Sh D	560			26860	0.08			
LK8-C105-□□-□□-□	(Y) 90 Sh A	310	3600	3.79x10 ³	10870	0.23	1	2.1 0	2106
	(R) 98 Sh A	525			25759	0.1			
	(G) 64 Sh D	655			47630	0.08			
LK8-C120-□□-□□-□	(R) 98 Sh A	685	3150	7.6x10 ³	32117	0.1	0.9	2.2 0	3280
	(G) 64 Sh D	825			53960	0.08			
	(R) 98 Sh A	940			38520	0.1			
LK8-C135-□□-□□-□	(R) 98 Sh A	940	2800	1.44x10 ²	66910	0.08	0.8	2.6 0	4971
	(G) 64 Sh D	1175							

Note:

1. Moment of inertia and unit N.W. are based on the maximum bore & shaft size.
2. Max. rotation speed does not take dynamic balance into account.
3. The elastic value is based on 20°C.